

KStrong® BRUTE™ Backer™ LE Dual 8.5 ft. Cable SRL-LE assembly with swivel rebar hooks at connector end and shock pack with Twin SRL connector at top (ANSI)

Model: UFS314006LD



DESIGN

- Robust & durable plastic casing
- Has swivel anchorage eye at anchorage end
- Ultralight design almost unnoticeable on the users back
- Galvanized steel wire rope
- Twin legged retractable lanyard with Stamped steel scaffold hook at termination end and shock pack at harness attachment end
- Twin SRL connector (UFC409151) for connection to the Dorsal attachment of harness
- Compatible to be used where anchor point not available above users head / can be used near a potential leading edge

LENGTH

8.5 ft.

CABLE

Material: Galvanized steel wire rope Ø3/16"
Minimum Breaking Strength: 3400 lbs. (1542 kg)

WEIGHT

8.77 lbs ± 0.22 lbs. (3978 gm ± 100 gm)

RELEVANT STANDARDS

Meets or Exceeds ANSI Z359.14-2021 Class 2

Class
2
Anchor above or
below dorsal D-ring

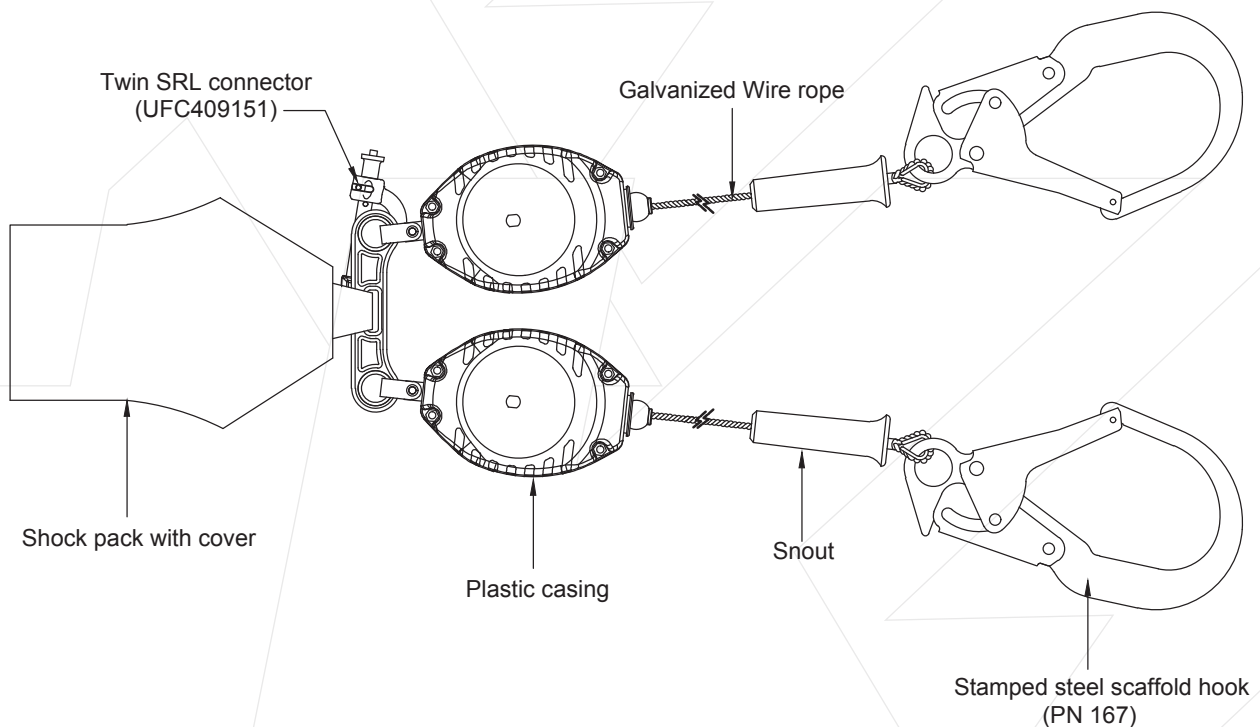

Batch #: _____ Serial #: _____
Date of First Use: _____